

LAMELA A - DRUGI SPRAT - STAN Sa 13

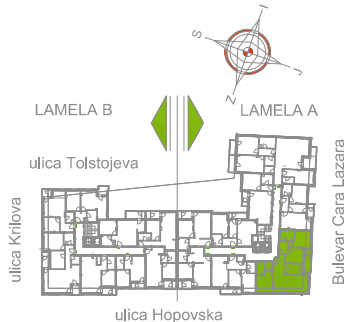

Sa13

Sa13-95,23 m²

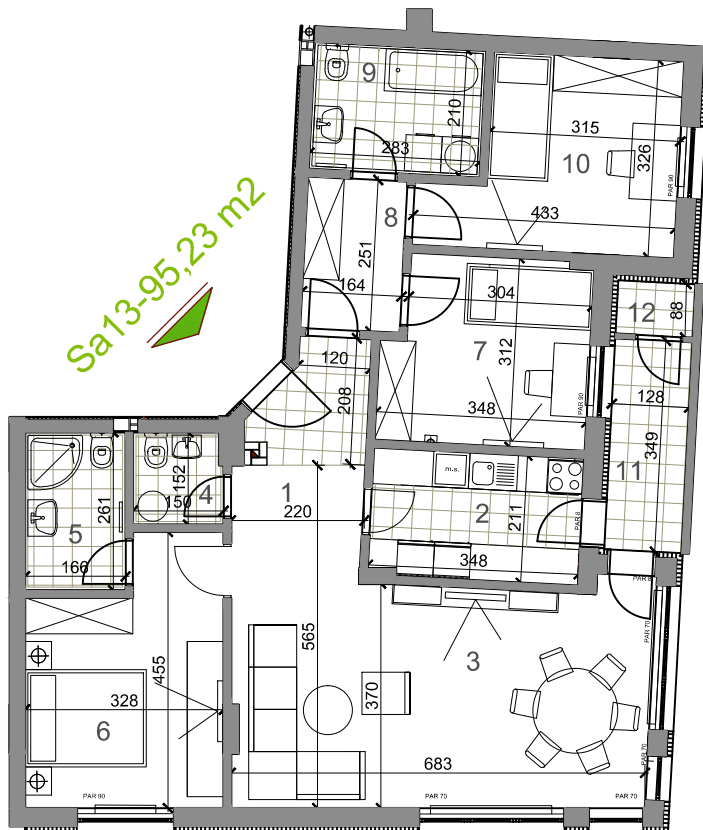

četvorosoban stan

| LAMELA A | osnovna površina [m ²] | kofarna površina [m ²] |
|-----------------------------|------------------------------------|------------------------------------|
| Sa13 = 95,23 m ² | | |
| ČETVOROSOBAN STAN | | |
| 1 P PREDSOBLJE | 4,04 | 3,93 |
| 2 KUHINJA | 7,27 | 7,36 |
| 3 DNEVNA SOBA | 29,55 | 29,15 |
| 4 WC | 2,34 | 2,17 |
| 5 KUPATILO | 4,33 | 4,30 |
| 6 SOBA | 13,14 | 12,76 |
| 7 SOBA | 10,12 | 9,85 |
| 8 DODATNA | 4,12 | 4,03 |
| 9 KUPATILO | 5,93 | 5,76 |
| 10 SOBA | 11,58 | 11,34 |
| 11 LOBA | 4,46 | 4,46 |
| 12 PLOŠTAVA | 1,13 | 1,10 |
| UKUPNO Sa13: | 97,50 | 95,23 |

LAMELA A - DRUGI SPRAT - STAN Sa 13