

LAMELA A - TREĆI SPRAT - STAN Sa 18

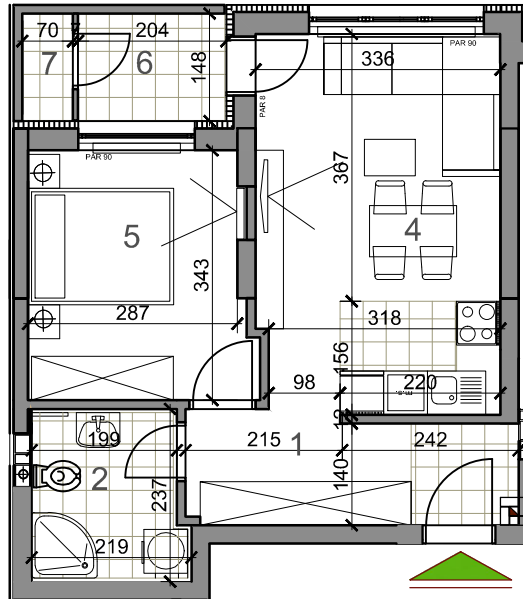
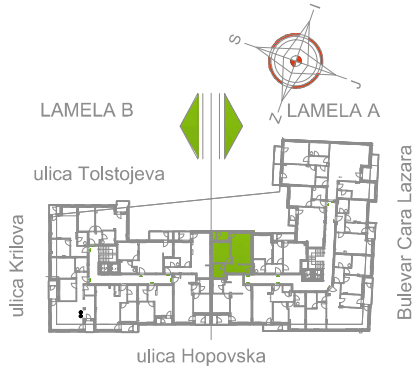

dvosoban stan

	osnovna površina [m ²]	korisna površina [m ²]
LAMELA A		
Sa18 = 42,48 m²		
DVOSOBAN STAN		
1 PREDŠOBLJE	6.59	6.40
2 KUPATILO	4.88	4.74
3 KUHNJA	3.44	3.34
4 DNEVNA SOBA	14.19	13.78
5 SOBA	10.51	10.20
6 TERASA	3.02	3.02
7 H.OSTAVA	1.03	1.00
UKUPNO Sa18:	43.66	42.48

Sa18-42,48 m²